

BOOTH DISPLAY SPECIFICATIONS

Linear or In-Line Booth

Linear Booths have one side exposed to an aisle and are generally arranged in a series along a straight line. Linear Booths are 10ft (3.05m) wide and 10ft (3.05m) deep, i.e. 10'x10'. The maximum back wall height limitation is 8ft (2.44m), except in the case of 10'x40' (400 square feet) and larger, which are permitted up to 12ft (3.66m) in the rear half of the booth space as long as the back side of any structure over 8ft (2.44m) is free of signage, graphics, and/or logos.

Display materials should not obstruct or block sight lines of neighboring exhibitors. The maximum height of 8ft (2.44m) is allowed only in the rear half of the booth space, with a 4ft (1.22m) height limit imposed on all materials in the remaining space forward to the aisle. (Note: When 3 or more Linear Booths are used in combination as a single exhibit space (10'x30'), the 4ft (1.22m) height limitation is applied only to that portion of exhibit space which is within 10ft (3.05m) of an adjoining booth.)

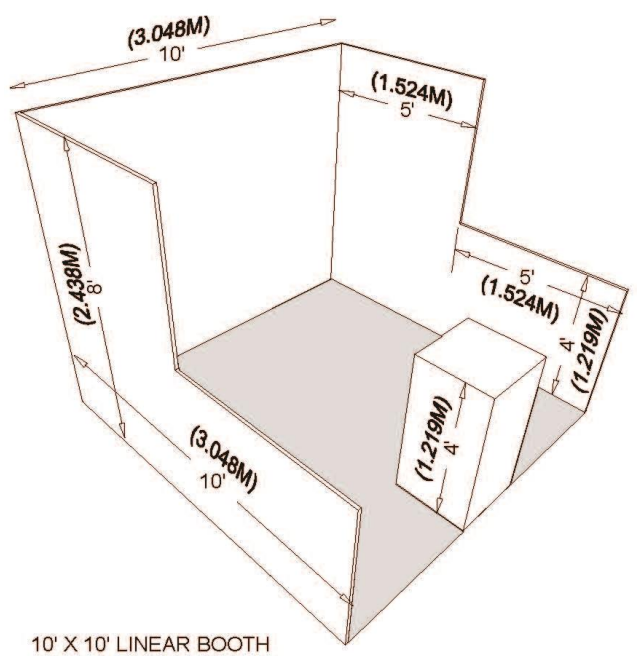
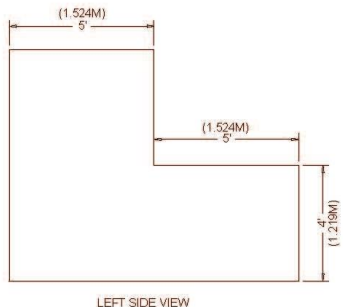
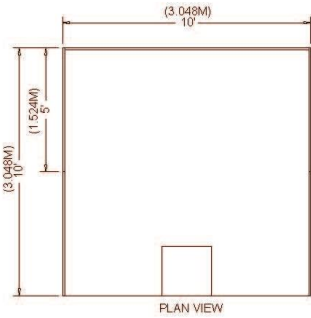

10' X 10' LINEAR BOOTH